

PROMONTORIO

TIVOLI CAPE VERDE HOTEL AND BUSINESS CENTRE
CIDADE DA PRAIA, CAPE VERDE
2005

Given the shortage and cost of skilled labour in Cape Verde an entirely new approach to the former hotel tower on the same site produced a revised scheme in response to the need for a construction system that would include as much prefabrication as possible.

In addition to a spa, the hotel programme was increased to 150-bdr with a focus on the 4-star business and conference segment. The main entrance and public areas were placed on the ridge of the Plateau, right next to the Presidential Palace and the scheme included the renovation of the former 18th century army fortress of Cidade da Praia. The bedrooms and suites are now located at the base of the cliff, slightly above sea level.

Like a loose Lego stack, the prefabricated bedrooms are positioned in a jagged configuration that evokes the shape of the cliff. The space between the cliff's wall and the organic inner elevation of the bedrooms is conceived as a botanic garden, irrigated with desalinated water from the adjoining coast.

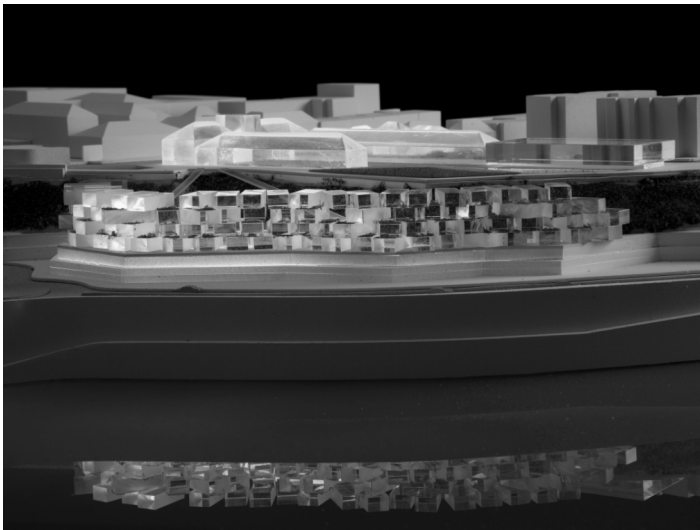

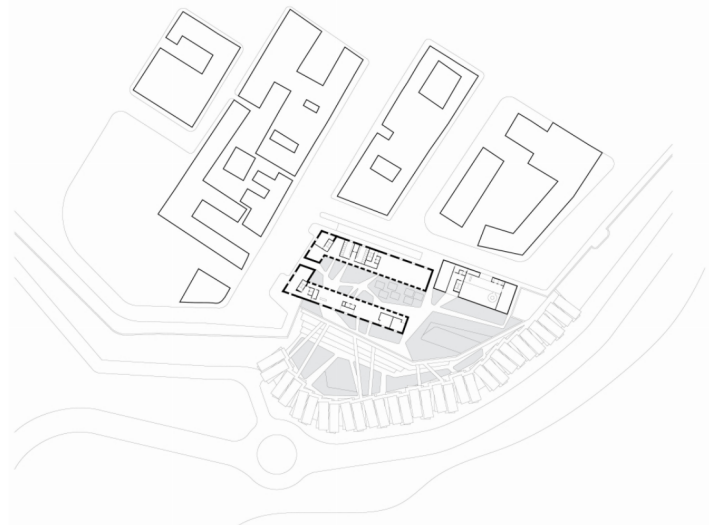
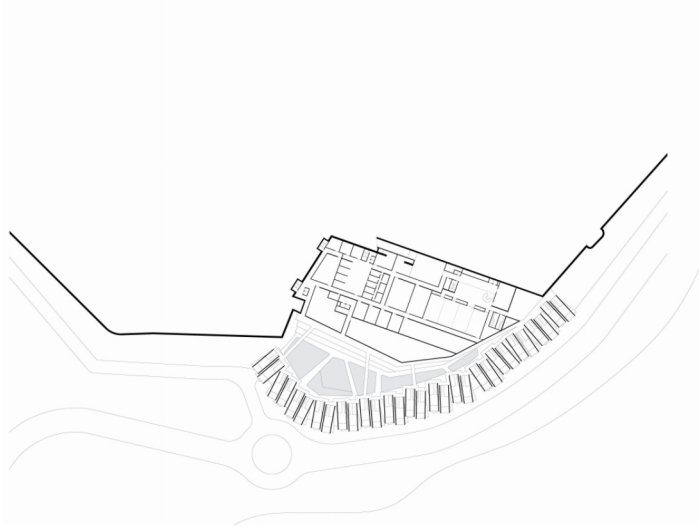

Location: Cidade da Praia (Santiago Island), Cape Verde
Developer: Espírito Santo Group
Operator: Tivoli Hotels/ Espírito Santo Tourism (Europe)
Programme: 150-bdr 4-star hotel and conference centre
Gross floor area: 12,000 sq. m
Estimated investment: EUR 12m
Project: 2005 (preliminary study)